

Mounting of RotoBed® Bedside Table

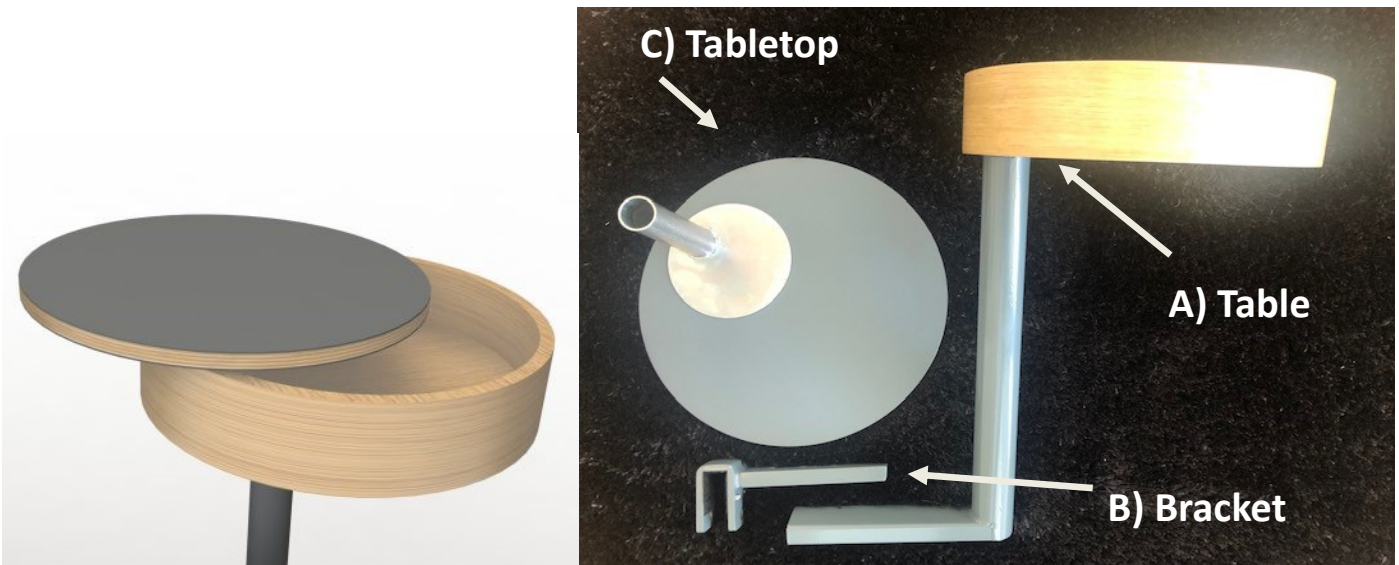

1. Move the bed to exit position.
Now raise the leg part to the highest possible.

2.1

If the bed has wooden bedrails: Push bracket (B) into the table (A) end. Leave 2 screwholes visible. Tighten the 2 screws with the allen key.

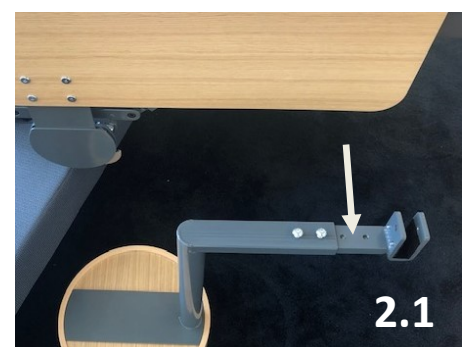

2.2

If the bed has metal bedrails: Push bracket (B) all the way into the table end (A). Tighten the 2 screws with the allen key.

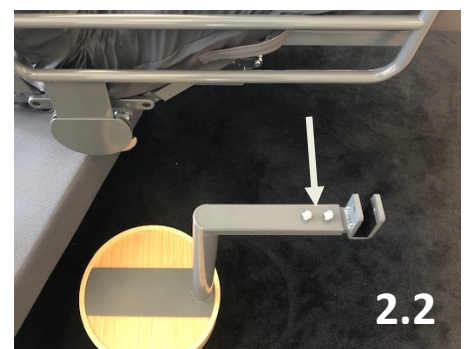

RotoBed®

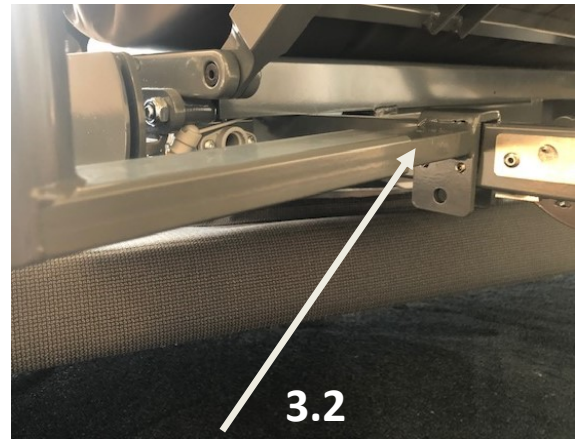

3. Place the bracket (B) under the leg part and above the bedframe with the opening horizontal (3.1). Then turn and place the bracket on the bedframe (3.2).

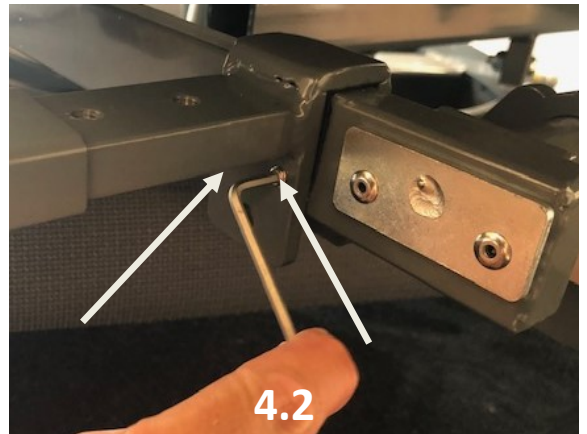
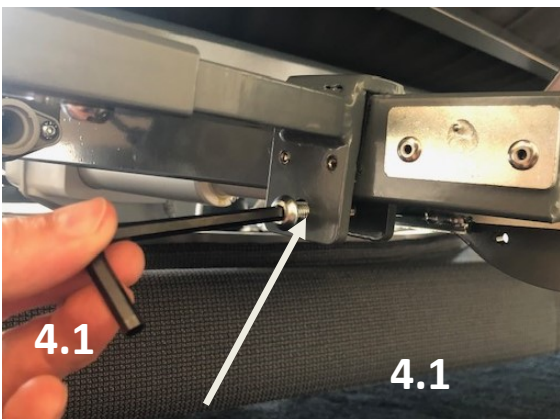

4. Tighten the large screws (4.1) until the table is steady and vertical. (4.2), Now tighten the 2 small screws.

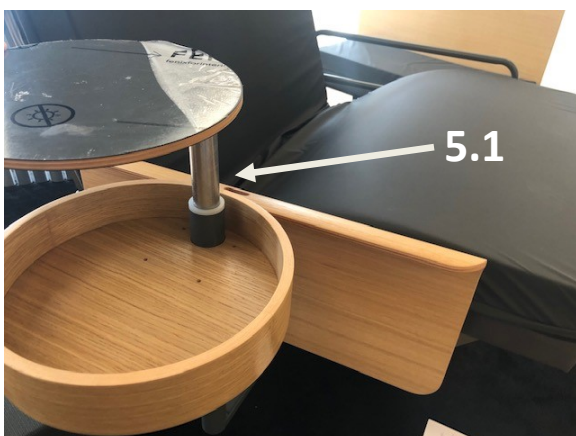

5. Insert the tabletop (C) into the table (5.1) and remove the film (5.2).

The table is now ready for use.

Attention!

Does your bed have wooden bedrails?

RotoBed® is programmed to run to an oblique exit position. If you choose to change this in favour of a perpendicular exit, be aware of the following:

If your bed has wooden bedrails at the mid section, the bedside table can NOT be mounted on the same side as the bed rotates. Doing so will make the table collide with the headboard

(see photo below).

The alternatives are:

- A. Mount the bedside table on the other side of the bed.
- B. Remove the bedrail in this side. Now you can mount the table closer to the bed (follow instruction 2.2 on page 1)

Attention!

The table will collide with the headboard if the bed is turning to a perpendicular exit.

